



THE REEF

1933 S BROADWAY, LOS ANGELES, CA 90007

FOR LEASE



Property Highlights

MOTIVATED ASKING RATE starting at \$2.00/SF, MG

800,000 SF building

OVER 134,000 RSF of contiguous space available

SELF-CONTAINED environment with multiple on-site amenities that include food service & a coffee bar

ONE OF THE largest floor plates available in Los Angeles

CONSIDERABLE ON-SITE single stall parking with over 1,100 parking spaces.

24-HR ACCESS with AC, conferencing facility & property manager on site

JOHN ANTHONY, SIOR
213.225.7218
john.anthony@kidder.com
LIC N° 01226464

CHRISTOPHER STECK
213.225.7231
christopher.steck@kidder.com
LIC N° 01841338

CHRISTOPHER GIORDANO
213.225.7219
christopher.giordano@kidder.com
LIC N° 01928706

PHIL TAGGART
213.225.7237
phil.taggart@kidder.com
LIC N° 02149291

FOR LEASE

THE REEF

1933 S BROADWAY, LOS ANGELES, CA 90007

Full Floor Plan

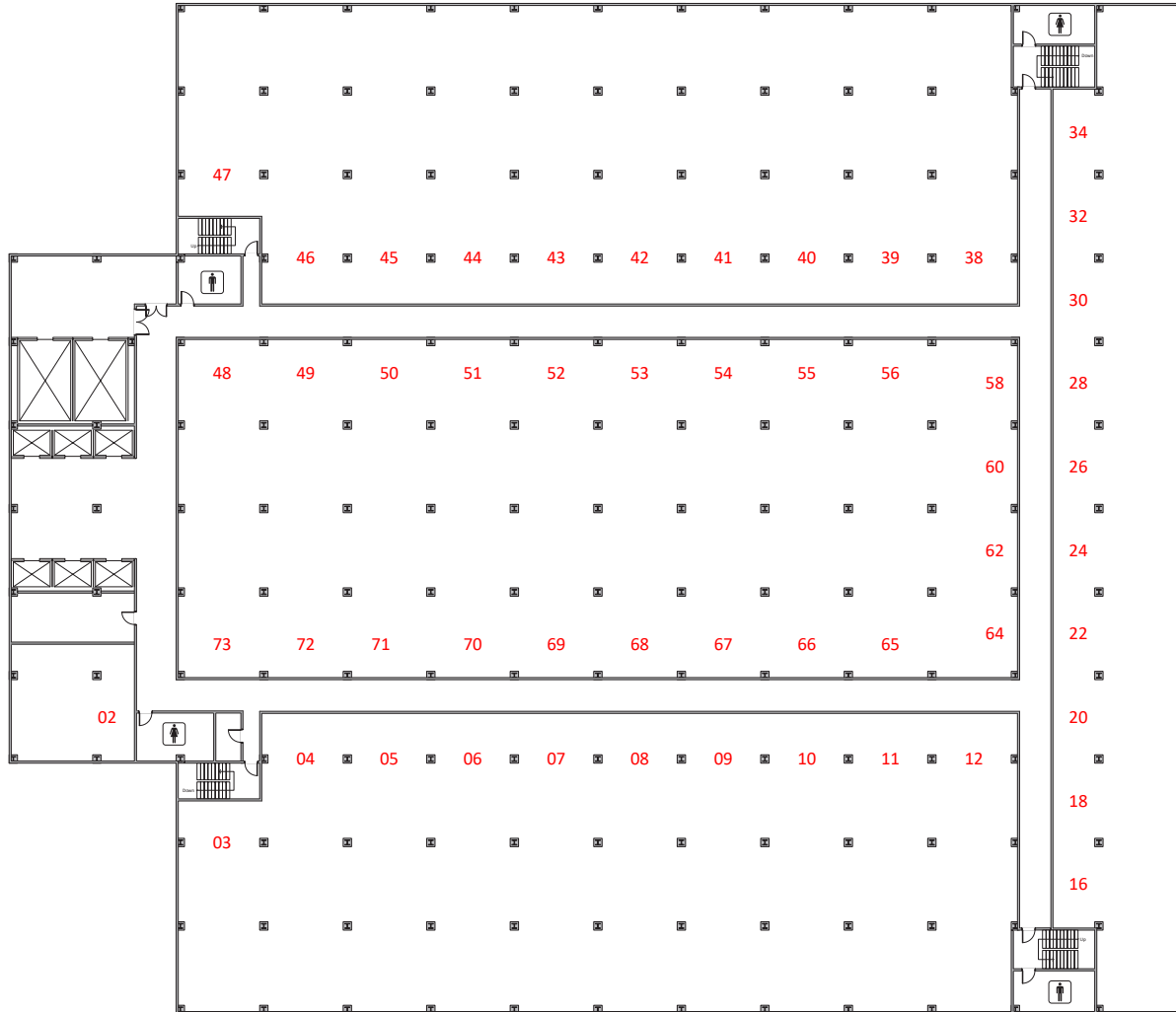

66,666

AVAILABLE SF EACH FLOOR
(FLOORS ARE DIVISIBLE)

\$2.00

MG ASKING RATE

2

CONTIGUOUS FULL
FLOORS AVAILABLE

KIDDER.COM

This information supplied herein is from sources we deem reliable. It is provided without any representation, warranty, or guarantee, expressed or implied as to its accuracy. Prospective Buyer or Tenant should conduct an independent investigation and verification of all matters deemed to be material, including, but not limited to, statements of income and expenses. Consult your attorney, accountant, or other professional advisor.



FOR LEASE

THE REEF

1933 S BROADWAY, LOS ANGELES, CA 90007

Full Floor Plan - Floor 12

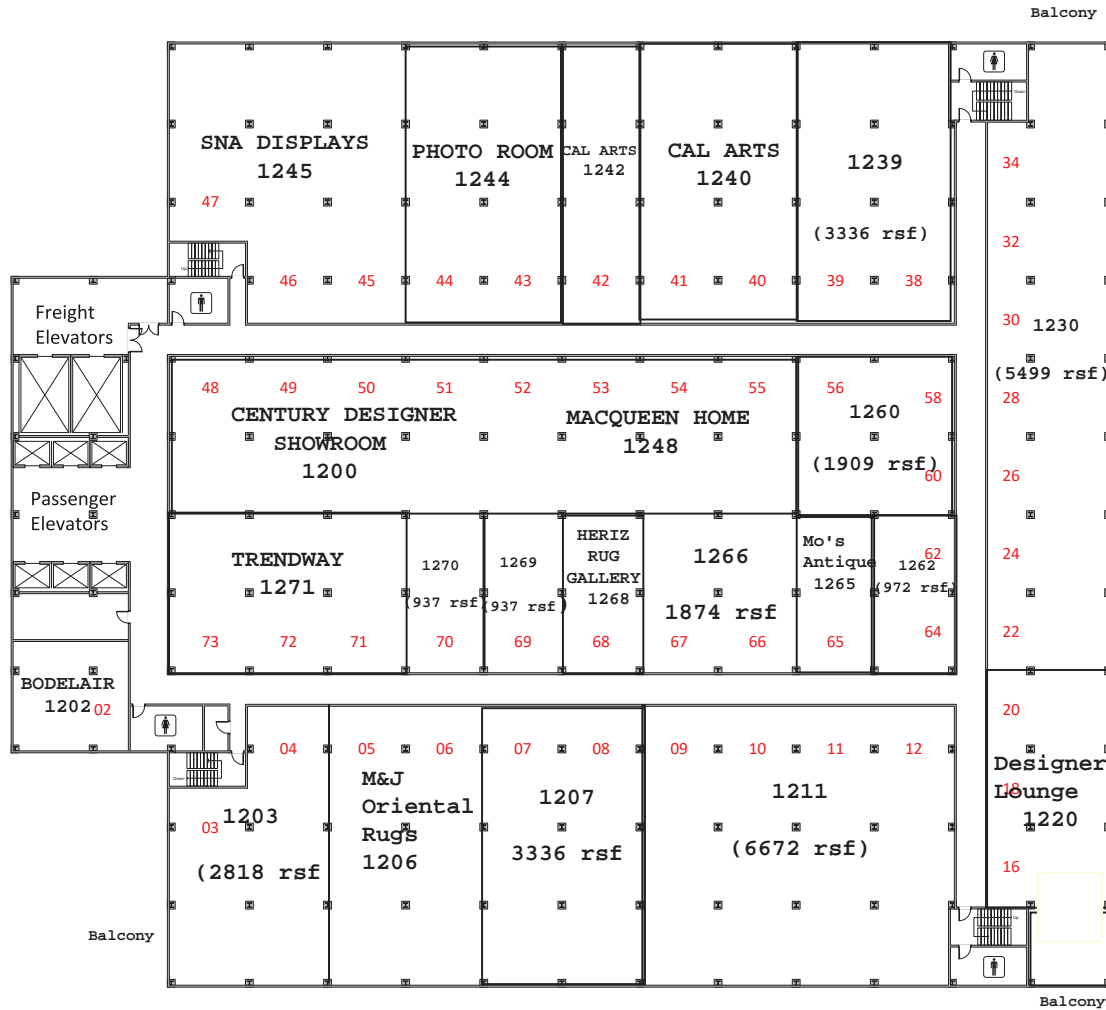

AVAILABILITIES

Unit #	Unit SF	Unit #	Unit SF
1203	2,818	1260	1,909
1207	3,336	1262	972
1211	6,672	1266	1,874
1230	5,499	1269	937
1239	3,336	1270	937

SUITES MAY BE COMBINED

KIDDER.COM

This information supplied herein is from sources we deem reliable. It is provided without any representation, warranty, or guarantee, expressed or implied as to its accuracy. Prospective Buyer or Tenant should conduct an independent investigation and verification of all matters deemed to be material, including, but not limited to, statements of income and expenses. Consult your attorney, accountant, or other professional advisor.



FOR LEASE

THE REEF

1933 S BROADWAY, LOS ANGELES, CA 90007

Full Floor Plan - Floor 11



AVAILABILITIES

Unit #	Unit SF	Unit #	Unit SF
1107-A	165	1118	719
1107-B	165	1122	719
1107-C	236	1141	1,668
1107-D	105	1151-C	105
1107-E	116	1151-E	93
1107-F	105	1152-A	183
1107-G	116	1153-A	93
1107-H	105	1153-C	105
1107-I	116	1153-D	105
1107-J	116	1167	317
1107-K	105	1168	1,783
1108	4,842		

SUITES MAY BE COMBINED

KIDDER.COM

This information supplied herein is from sources we deem reliable. It is provided without any representation, warranty, or guarantee, expressed or implied as to its accuracy. Prospective Buyer or Tenant should conduct an independent investigation and verification of all matters deemed to be material, including, but not limited to, statements of income and expenses. Consult your attorney, accountant, or other professional advisor.



FOR LEASE

THE REEF

1933 S BROADWAY, LOS ANGELES, CA 90007

Amenities - Floor 11

Mail service

Cafe

Guest WiFi across the floor

Wheelchair accessible

Gender neutral bathroom

Community kitchen with sink, dish rack, microwave, and refrigerator

Paint and solvent utility sink

Private conference room bookings

Discounted rates for creative labs bookings

SHARED SPACE FOR RENTAL INCLUDES

ATELIER Shared workroom for apparel designers and seamstresses.

MEDIA LAB Photo Studio with private makeup and wardrobe rooms, and green screen, Podcast Studio - Soundproof room with three microphones for recording on ProTools, Audacity and Audition

CO-WORKING / FLEX SPACE A designated space with desks, meeting tables and sofas.

MEETING ROOMS Private rooms for meetings, fittings, readings and phone call conferences. Rooms can seat 8 to 12 individuals

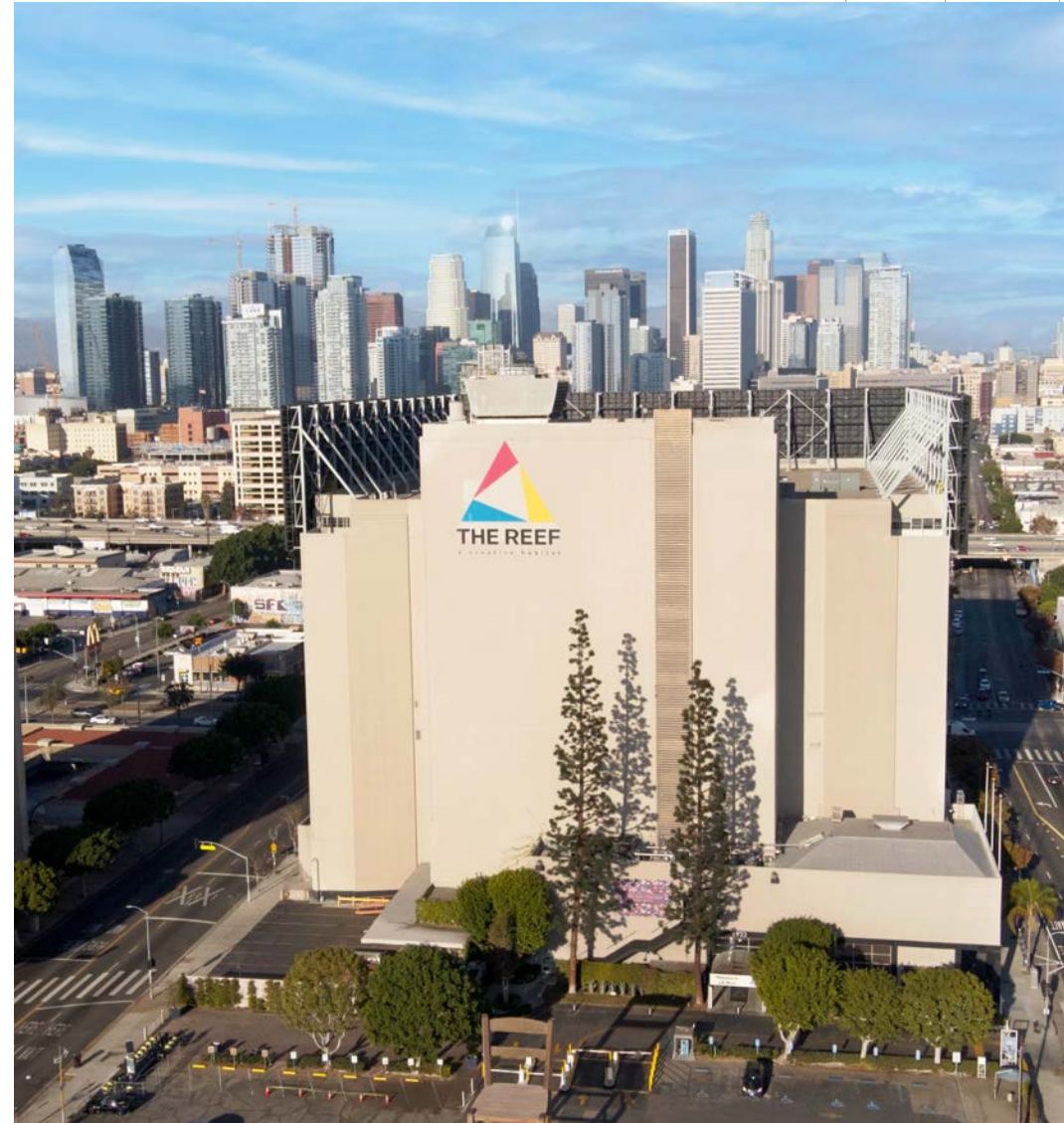

KIDDER.COM

This information supplied herein is from sources we deem reliable. It is provided without any representation, warranty, or guarantee, expressed or implied as to its accuracy. Prospective Buyer or Tenant should conduct an independent investigation and verification of all matters deemed to be material, including, but not limited to, statements of income and expenses. Consult your attorney, accountant, or other professional advisor.

km Kidder Mathews

FOR LEASE

THE REEF

1933 S BROADWAY, LOS ANGELES, CA 90007

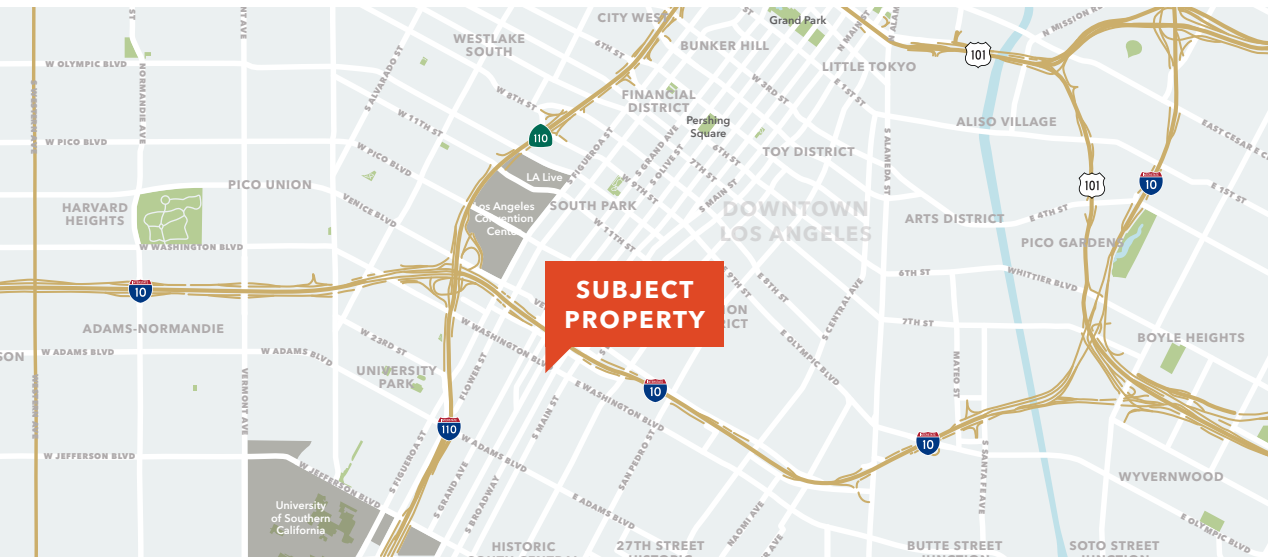

JOHN ANTHONY, SIOR
213.225.7218
john.anthony@kidder.com
LIC N° 01226464

CHRISTOPHER STECK
213.225.7231
christopher.steck@kidder.com
LIC N° 01841338

CHRISTOPHER GIORDANO
213.225.7219
christopher.giordano@kidder.com
LIC N° 01928706

PHIL TAGGART
213.225.7237
phil.taggart@kidder.com
LIC N° 02149291

KIDDER.COM

This information supplied herein is from sources we deem reliable. It is provided without any representation, warranty, or guarantee, expressed or implied as to its accuracy. Prospective Buyer or Tenant should conduct an independent investigation and verification of all matters deemed to be material, including, but not limited to, statements of income and expenses. Consult your attorney, accountant, or other professional advisor.



FOR LEASE

THE REEF

1933 S BROADWAY, LOS ANGELES, CA 90007

THE REEF bring businesses and communities together.

THE REEF unites LA Mart, Maker City LA, Shipfront and Magic Box under one roof to support all types of visionaries. With facilities for media production, sales, fulfillment and warehousing, events, and experiential marketing, THE REEF is downtown Los Angeles' most unique destination for creative space to grow your business.

[➤ READ MORE ON THE-REEF.COM](#)



KIDDER.COM

This information supplied herein is from sources we deem reliable. It is provided without any representation, warranty, or guarantee, expressed or implied as to its accuracy. Prospective Buyer or Tenant should conduct an independent investigation and verification of all matters deemed to be material, including, but not limited to, statements of income and expenses. Consult your attorney, accountant, or other professional advisor.

km Kidder Mathews